

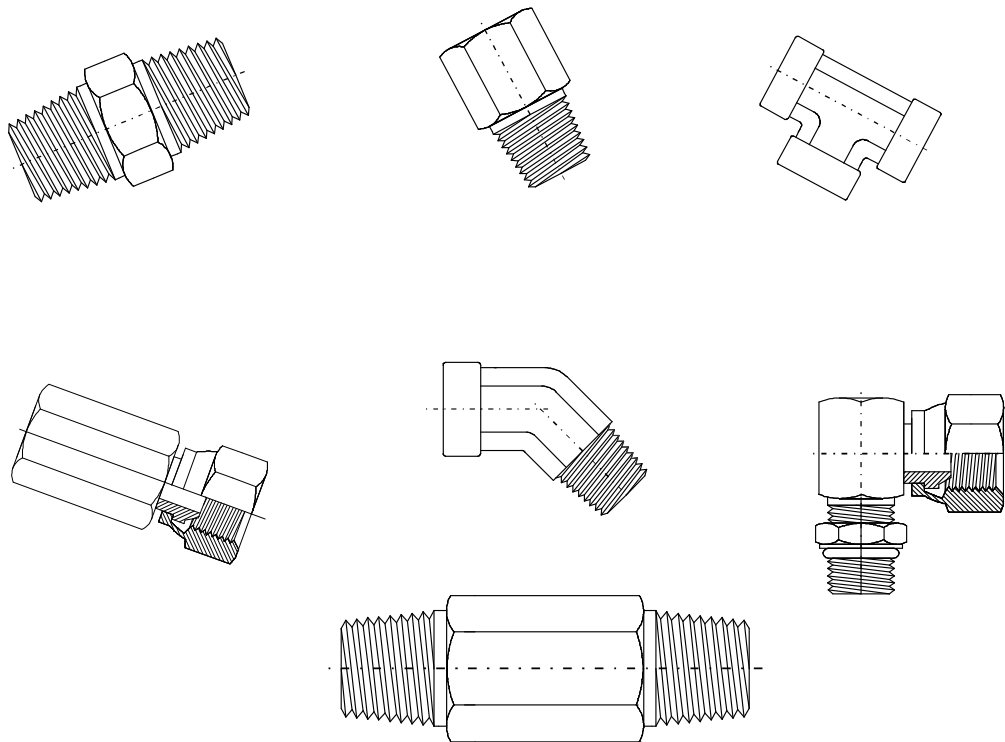

Adaptadores



SAE J514

ADAPTADORES - SAE J514



ADAPTADORES MACHO NPT (Adapters Male/Male)

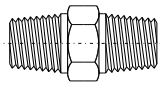

140137
Pág. 8



140237
Pág. 9

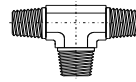

140437
Pág. 9



MM (Longo)
Pág. 10

ADAPTADORES MACHO / FÊMEA NPT (Adapters Male/Female)

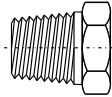

140140
Pág. 11

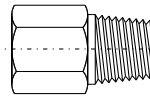

140139
Pág. 12

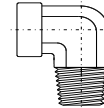

140239
Pág. 13

ADAPTADORES MACHO/FÊMEA NPT (Adapters Male/Female)

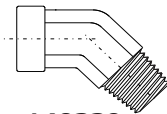

140339
Pág. 14

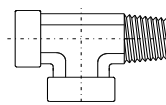

140424
Pág. 14

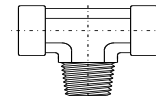

140425
Pág. 14

ADAPTADORES FÊMEA/FÊMEA NPT (Adapters Female/Female)

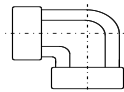

140138
Pág. 15

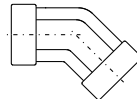

140238
Pág. 16

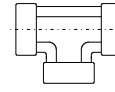

140338
Pág. 16

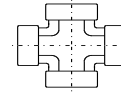

140438
Pág. 16

140538
Pág. 16

ADAPTADORES PORCA GIRATÓRIA NPSM/MACHO NPT (Female Swivel NPSM/Male NPT)

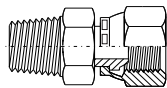

140130
Pág. 17

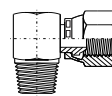

140230
Pág. 18

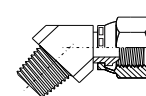

140330
Pág. 19

ADAPTADORES PORCA GIRATÓRIA NPSM / MACHO UNF (Female Swivel NPSM/Male UN/UNF)

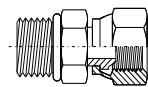

140157
Pág. 20

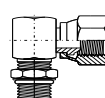

140257
Pág. 21

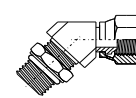

140357
Pág. 22

ADAPTADORES PORCA GIRATÓRIA NPSM / FÊMEA NPT (Female Swivel NPSM/Female NPT)

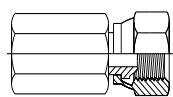

140131
Pág. 23

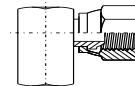

140231
Pág. 24

ADAPTADORES - SAE J514

ADAPTADOR MACHO NPT (Male Niple)

140137.....

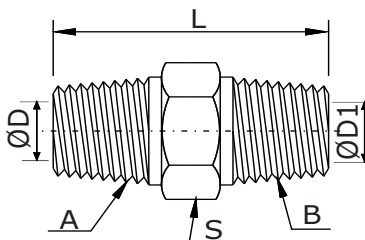

Ref.	Rosca A NPT	Rosca B NPT	L	ØD	ØD1	S
140137-2-2 C	1/8	1/8	27	5	5	7/16
140137-4-2 C	1/4	1/8	32	7	5	5/8
140137-4-4 C	1/4	1/4	37	7	7	5/8
140137-6-2 C	3/8	1/8	37	10	5	3/4
140137-6-4 C	3/8	1/4	37	10	7	3/4
140137-6-6 C	3/8	3/8	37	10	10	3/4
140137-8-2 C	1/2	1/8	39	14	5	7/8
140137-8-4 C	1/2	1/4	43	14	7	7/8
140137-8-6 C	1/2	3/8	43	14	10	7/8
140137-8-8 C	1/2	1/2	48	14	14	7/8
140137-12-4 C	3/4	1/4	45	18	7	1.1/8
140137-12-6 C	3/4	3/8	45	18	10	1.1/8
140137-12-8 C	3/4	1/2	50	18	14	1.1/8
140137-12-12 C	3/4	3/4	50	18	18	1.1/8
140137-16-4 C	1	1/4	50	24	7	1.3/8
140137-16-12 C	1	3/4	53	24	18	1.3/8
140137-16-16 C	1	1	59	24	24	1.3/8
140137-20-16 C	1.1/4	1	62	32	24	1.3/4
140137-20-20 C	1.1/4	1.1/4	63	32	32	1.3/4
140137-24-24 C	1.1/2	1.1/2	66	38	38	2
140137-32-32 C	2	2	72	49	49	2.1/2

Adaptador com ref. em Aço Carbono (C)

1 - Materiais dos Adaptadores: **Aço Inoxidável (S) = 140137-8-8 S**
Latão (B) = 140137-8-8 B

2 - Consulte para outras combinações de Rosca NPT.

ADAPTADORES - SAE J514

JOELHO MACHO NPT (Male Thread Elbow)

140237.....

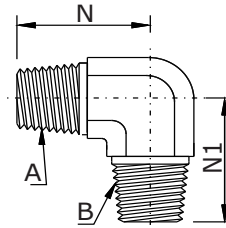

Ref.	Rosca A NPT	Rosca B NPT	N	N 1
140237-2-2 C	1/8	1/8	20	20
140237-4-4 C	1/4	1/4	28	28
140237-6-4 C	3/8	1/4	31	31
140237-6-6 C	3/8	3/8	31	31
140237-8-6 C	1/2	3/8	37	36
140237-8-8 C	1/2	1/2	37	37
140237-12-8 C	3/4	1/2	40	37
140237-12-12 C	3/4	3/4	40	40
140237-16-16 C	1	1	50	50
140237-20-20 C	1.1/4	1.1/4	56	56
140237-24-24 C	1.1/2	1.1/2	59	59
140237-32-32 C	2	2	76	76

Adaptador com ref. em Aço Carbono (C)

- 1 - Materiais dos Adaptadores: **Aço Inoxidável (S) = 140237-8-8 S**
- 2 - Consulte para outras combinações de Rosca NPT.

TE MACHO NPT (Male Thread Tee)

140437.....

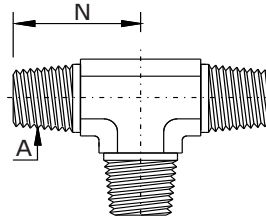

Ref.	Rosca A NPT (3x)	N
140437-2-2-2 C	1/8	20
140437-4-4-4 C	1/4	28
140437-6-6-6 C	3/8	31
140437-8-8-8 C	1/2	31
140437-12-12-12 C	3/4	37
140437-16-16-16 C	1	50
140437-20-20-20 C	1.1/4	56
140437-24-24-24 C	1.1/2	59
140437-32-32-32 C	2	76

Adaptador com ref. em Aço Carbono (C)

- 1 - Materiais dos Adaptadores: **Aço Inoxidável (S) = 140437-8-8-8 S**
- 2 - Consulte para outras combinações de Rosca NPT.

ADAPTADORES - SAE J514

ADAPTADOR MACHO NPT LONGO (Extendet Male Niple)

MM.....

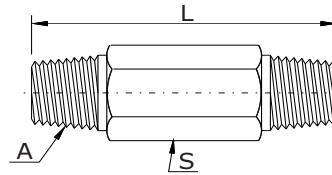

Ref.	Rosca A NPT	L	S
MMS 1/8X1/8 NPT X 38,1	1/8	38,1	7/16
MMS 1/8X1/8 NPT X 50,8	1/8	50,8	7/16
MMS 1/8X1/8 NPT X 63,5	1/8	63,5	7/16
MMS 1/8X1/8 NPT X 76,2	1/8	76,2	7/16
MMS 1/4X1/4 NPT X 38,1	1/4	26,9	5/8
MMS 1/4X1/4 NPT X 50,8	1/4	50,8	5/8
MMS 1/4X1/4 NPT X 63,5	1/4	63,5	5/8
MMS 1/4X1/4 NPT X 76,2	1/4	76,2	5/8
MMS 1/4X1/4 NPT X 101,6	1/4	101,6	5/8
MMS 1/2X1/2 NPT X 50,8	1/2	50,8	7/8
MMS 1/2X1/2 NPT X 76,2	1/2	76,2	7/8

Adaptador com ref. em Aço Carbono (S)

- 1 - Materiais dos Adaptadores: **Aço Inoxidável (SS) = MMSS 1/4X1/4 NPT X 50,8**
Latão (B) = MMB 1/4X1/4 NPT X 50,8
- 2 - Consulte para outras combinações de Rosca NPT e comprimentos (L).

ADAPTADORES - SAE J514

ADAPTADOR MACHO/FÊMEA NPT (Thread Reducer)

140140.....

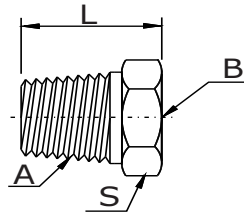

Lado "A" (Macho) for maior que "B" (Fêmea).

Ref.	Rosca A NPT	Rosca B NPT	L	S
140140-4-2 C	1/4	1/8	22	5/8
140140-6-2 C	3/8	1/8	22	3/4
140140-6-4 C	3/8	1/4	22	3/4
140140-8-2 C	1/2	1/8	28	7/8
140140-8-4 C	1/2	1/4	28	7/8
140140-8-6 C	1/2	3/8	28	7/8
140140-12-4 C	3/4	1/4	30	1.1/8
140140-12-6 C	3/4	3/8	30	1.1/8
140140-12-8 C	3/4	1/2	30	1.1/8
140140-16-6 C	1	3/8	35	1.3/8
140140-16-8 C	1	1/2	35	1.3/8
140140-16-12 C	1	3/4	35	1.3/8
140140-20-8 C	1.1/4	1/2	37	1.3/4
140140-20-12 C	1.1/4	3/4	37	1.3/4
140140-20-16 C	1.1/4	1	37	1.3/4
140140-24-12 C	1.1/2	3/4	40	2
140140-24-16 C	1.1/2	1	40	2
140140-24-20 C	1.1/2	1.1/4	40	2
140140-32-8 C	2	1/2	45	2.1/2
140140-32-20 C	2	1.1/4	45	2.1/2
140140-32-24 C	2	1.1/2	45	2.1/2

Adaptador com ref. em Aço Carbono (C)

1 - Materiais dos Adaptadores: **Aço Inoxidável (S) = 140140-8-4 S**
Latão (B) = 140140-8-4 B

2 - Consulte para outras combinações de Rosca NPT.

OBS: Quando "B" (Fêmea) for igual ou maior que "A" (Macho),
usar código da peça **140139 (Pág.)**

ADAPTADORES - SAE J514

ADAPTADOR FÊMEA / MACHO NPT (Thread expander / Adapter)

140139.....

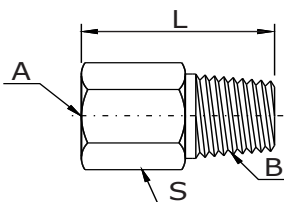

Lado "A" (Fêmea) for igual ou maior que "B" (Macho).

Ref.	Rosca A NPT	Rosca B NPT	L	S
140139-2-2 C	1/8	1/8	26	5/8
140139-4-2 C	1/4	1/8	31	3/4
140139-4-4 C	1/4	1/4	35	3/4
140139-6-2 C	3/8	1/8	32	7/8
140139-6-4 C	3/8	1/4	37	7/8
140139-6-6 C	3/8	3/8	37	7/8
140139-8-2 C	1/2	1/8	38	1.1/8
140139-8-4 C	1/2	1/4	43	1.1/8
140139-8-6 C	1/2	3/8	43	1.1/8
140139-8-8 C	1/2	1/2	43	1.1/8
140139-12-4 C	3/4	1/4	45	1.3/8
140139-12-8 C	3/4	1/2	49	1.3/8
140139-12-12 C	3/4	3/4	49	1.3/8
140139-16-8 C	1	1/2	56	1.5/8
140139-16-12 C	1	3/4	56	1.5/8
140139-16-16 C	1	1	60	1.5/8
140139-20-16 C	1.1/4	1	63	2
140139-20-20 C	1.1/4	1.1/4	63	2
140139-24-24 C	1.1/2	1.1/2	64	2.3/8

Adaptador com ref. em Aço Carbono (C)

1 - Materiais dos Adaptadores: **Aço Inoxidável (S) = 140139-8-4 S**
Latão (B) = 140139-8-4 B

2 - Consulte para outras combinações de Rosca NPT.

OBS: Quando "A" (Fêmea) for menor que "B" (Macho),
usar código da peça **140140 (Pág.)**

ADAPTADORES - SAE J514

ADAPTADOR MACHO/FÊMEA NPT (Thread expander / Adapter)

140239.....

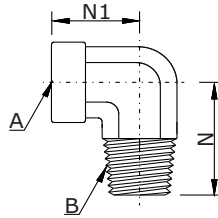

Ref.	Rosca A NPT	Rosca B NPT	N	N 1
140239-2-2 C	1/8	1/8	20	17
140239-2-4 C	1/8	1/4	28	17
140239-4-4 C	1/4	1/4	28	22
140239-4-6 C	1/4	3/8	31	22
140239-6-6 C	3/8	3/8	31	26
140239-6-8 C	3/8	1/2	33	31
140239-8-6 C	1/2	3/8	38	32
140239-8-8 C	1/2	1/2	37	31
140239-8-12 C	1/2	3/4	40	35
140239-12-8 C	3/4	1/2	40	31
140239-12-12 C	3/4	3/4	40	35
140239-16-16 C	1	1	50	41
140239-20-20 C	1.1/4	1.1/4	61	43
140239-24-24 C	1.1/2	1.1/2	67	53
140239-32-32 C	2	2	76	61

Adaptador com ref. em Aço Carbono (C)

1 - Materiais dos Adaptadores: **Aço Inoxidável (S) = 140239-8-8 S**

2 - Consulte para outras combinações de Rosca NPT.

ADAPTADORES - SAE J514

CURVA FÊMEA / MACHO NPT (Male Female Thread 45° Elbow)

140139.....

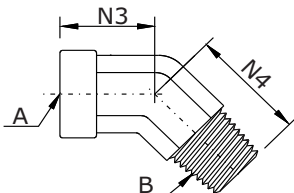

Ref.	Rosca A NPT	Rosca B NPT	N 3	N 4
140339-2-2 C	1/8	1/8	12	18
140339-4-4 C	1/4	1/4	16	26
140339-6-6 C	3/8	3/8	18	26
140339-8-8 C	1/2	1/2	23	34
140339-12-12 C	3/4	3/4	25	35
140339-16-16 C	1	1	29	44
140339-20-20 C	1.1/4	1.1/4	41	46
140339-24-24 C	1.1/2	1.1/2	43	52
140339-32-32 C	2	2	56	55

Adaptador com ref. em Aço Carbono (C)

TE FÊMEA / MACHO NPT (Male Female Thread Tee)

140424.....

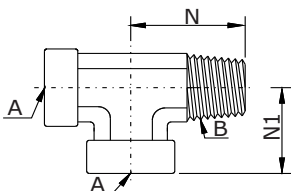

Ref.	Rosca A NPT	Rosca B NPT	N	N 1
140424-2-2-2 C	1/8	1/8	20	17
140424-4-4-4 C	1/4	1/4	28	22
140424-6-6-6 C	3/8	3/8	31	26
140424-8-8-8 C	1/2	1/2	37	31
140424-12-12-12 C	3/4	3/4	40	35
140424-16-16-16 C	1	1	50	41
140424-20-20-20 C	1.1/4	1.1/4	60	43
140424-24-24-24 C	1.1/2	1.1/2	67	53
140424-32-32-32 C	2	2	76	61

Adaptador com ref. em Aço Carbono (C)

TE FÊMEA / MACHO NPT (Male Female Thread Tee)

140425.....

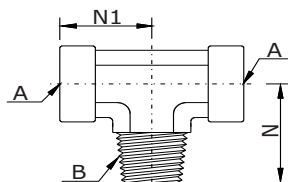

Ref.	Rosca A NPT	Rosca B NPT	N	N 1
140425-2-2-2 C	1/8	1/8	20	17
140425-4-4-4 C	1/4	1/4	28	22
140425-6-6-6 C	3/8	3/8	31	26
140425-8-8-8 C	1/2	1/2	37	31
140425-12-12-12 C	3/4	3/4	40	35
140425-16-16-16 C	1	1	50	41
140425-20-20-20 C	1.1/4	1.1/4	60	43
140425-24-24-24 C	1.1/2	1.1/2	67	53
140425-32-32-32 C	2	2	76	61

Adaptador com ref. em Aço Carbono (C)

1 - Materiais dos Adaptadores: **Aço Inoxidável (S) = 140339-8-8 S**
140424-8-8-8 S
140425-8-8-8 S

2 - Consulte para outras combinações de Rosca NPT.

ADAPTADORES - SAE J514

ADAPTADOR FÊMEA NPT (Female Thread Coupling)

140138.....

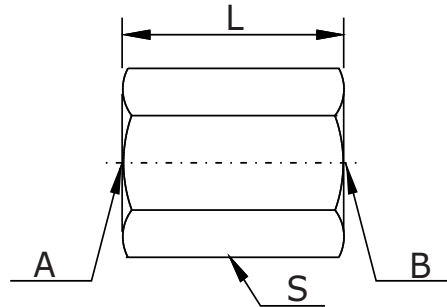

Ref.	Rosca A NPT	Rosca B NPT	W	W1	L	S
140138-2-2 C	1/8	1/8	16	16	19	5/8
140138-4-2 C	1/4	1/8	19	16	24	3/4
140138-4-4 C	1/4	1/4	19	19	29	3/4
140138-6-2 C	3/8	1/8	22	16	26	7/8
140138-6-4 C	3/8	1/4	22	19	29	7/8
140138-6-6 C	3/8	3/8	22	22	29	7/8
140138-8-4 C	1/2	1/4	29	19	35	1.1/8
140138-8-6 C	1/2	3/8	29	22	38	1.1/8
140138-8-8 C	1/2	1/2	29	29	38	1.1/4
140138-12-4 C	3/4	1/4	35	19	39	1.3/8
140138-12-8 C	3/4	1/2	35	29	48	1.3/8
140138-12-12 C	3/4	3/4	35	35	39	1.1/2
140138-16-8 C	1	1/2	41	29	45	1.5/8
140138-16-12 C	1	3/4	41	35	45	1.5/8
140138-16-16 C	1	1	41	41	48	1.5/8
140138-20-16 C	1.1/4	1	51	41	49	2
140138-20-20 C	1.1/4	1.1/4	51	51	49	2
140138-24-20 C	1.1/2	1.1/4	61	51	49	2.3/8
140138-24-24 C	1.1/2	1.1/2	61	61	49	2.3/8
140138-32-32 C	2	2	73	73	50	2.7/8

Adaptador com ref. em Aço Carbono (C)

- 1 - Materiais dos Adaptadores: **Aço Inoxidável (S) = 140138-8-8 S**
Latão (B) = 140138-8-8 B
- 2 - Consulte para outras combinações de Rosca NPT.

ADAPTADORES - SAE J514

JOELHO FÊMEA NPT (Female Thread Elbow)

140238.....

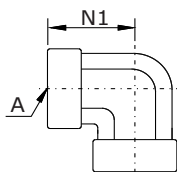

Ref.	Rosca A NPT (2x)	N1
140238-2-2 C	1/8	17
140238-4-4 C	1/4	22
140238-6-6 C	3/8	26
140238-8-8 C	1/2	31
140238-12-12 C	3/4	35
140238-16-16 C	1	41
140238-20-20 C	1.1/4	43
140238-24-24 C	1.1/2	53
140238-32-32 C	2	61

Adaptador com ref. em Aço Carbono (C)

CURVA FÊMEA NPT (Female Thread 45° Elbow)

140338.....

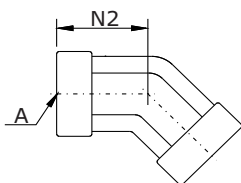

Ref.	Rosca A NPT (2x)	N 2
140338-2-2 C	1/8	13
140338-4-4 C	1/4	18
140338-6-6 C	3/8	19
140338-8-8 C	1/2	24
140338-12-12 C	3/4	25
140338-16-16 C	1	30
140338-20-20 C	1.1/4	37
140338-24-24 C	1.1/2	37
140338-32-32 C	2	40

Adaptador com ref. em Aço Carbono (C)

TE FÊMEA NPT (Female Thread Tee)

140438.....

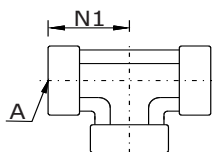

Ref.	Rosca A NPT (2x)	N1
140438-2-2-2 C	1/8	17
140438-4-4-4 C	1/4	22
140438-6-6-6 C	3/8	26
140438-8-8-8 C	1/2	31
140438-12-12-12 C	3/4	35
140438-16-16-16 C	1	41
140438-20-20-20 C	1.1/4	43
140438-24-24-24 C	1.1/2	53
140438-32-32-32 C	2	61

Adaptador com ref. em Aço Carbono (C)

CRUZETA FÊMEA NPT (Female Thread Cross)

140538.....

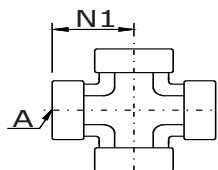

Ref.	Rosca A NPT (2x)	N1
140538-2-2-2-2 C	1/8	17
140538-4-4-4-4 C	1/4	22
140538-6-6-6-6 C	3/8	26
140538-8-8-8-8 C	1/2	31
140538-12-12-12-12 C	3/4	35
140538-16-16-16-16 C	1	41
140538-20-20-20-20 C	1.1/4	43
140538-24-24-24-24 C	1.1/2	53
140538-32-32-32-32 C	2	61

Adaptador com ref. em Aço Carbono (C)

1 - Materiais dos Adaptadores: **Aço Inoxidável (S) =** 140238-8-8 S
140338-8-8 S
140438-8-8-8 C
140538-8-8-8-8 C

ADAPTADORES - SAE J514

UNIÃO PORCA GIRATÓRIA NPSM / MACHO NPT (Swivel Male Stud)

140130.....

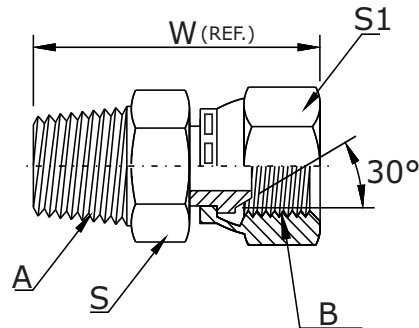

Ref.	Rosca A NPT	Rosca B NPSM	W (Ref.)	S	S1
140130-2-2 C	1/8	1/8	28	9/16	9/16
140130-2-4 C	1/8	1/4	32	5/8	3/4
140130-4-4 C	1/4	1/4	36	3/4	3/4
140130-4-6 C	1/4	3/8	37	7/8	7/8
140130-4-8 C	1/4	1/2	44	15/16	1
140130-6-4 C	3/8	1/4	38	3/4	3/4
140130-6-6 C	3/8	3/8	38	7/8	7/8
140130-6-8 C	3/8	1/2	44	15/16	1
140130-8-6 C	1/2	3/8	43	7/8	7/8
140130-8-8 C	1/2	1/2	49	1	1
140130-8-12 C	1/2	3/4	52	1.1/4	1.1/4
140130-12-8 C	3/4	1/2	49	1.1/8	1
140130-12-12 C	3/4	3/4	52	1.1/4	1.1/4
140130-12-16 C	3/4	1	55	1.1/2	1.1/2
140130-16-12 C	1	3/4	58	1.3/8	1.1/2
140130-16-16 C	1	1	60	1.1/2	1.1/2
140130-16-20 C	1	1.1/4	61	1.3/4	1.7/8
140130-20-16 C	1.1/4	1	63	1.7/8	1.1/2
140130-20-20 C	1.1/4	1.1/4	63	1.7/8	1.7/8
140130-24-24 C	1.1/2	1.1/2	66	2.1/8	2.1/8
140130-32-32 C	2	2	71	2.5/8	2.5/8

Adaptador com ref. em Aço Carbono (C)

1 - Materiais dos Adaptadores: **Aço Inoxidável (S) = 140130-8-8 S**

2 - Consulte para outras combinações de Rosca NPT / NPSM.

ADAPTADORES - SAE J514

JOELHO PORCA GIRATÓRIA NPSM / MACHO NPT (Swivel Male Elbow)

140230.....

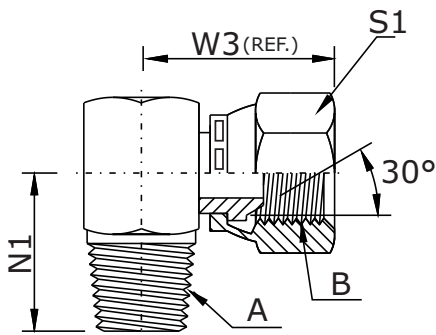

Ref.	Rosca A NPT	Rosca B NPSM	W3 (Ref.)	N 1	S1
140230-2-2 C	1/8	1/8	22	18	9/16
140230-4-4 C	1/4	1/4	27	28	3/4
140230-4-6 C	1/4	3/8	33	28	7/8
140230-6-4 C	3/8	1/4	30	31	3/4
140230-6-6 C	3/8	3/8	33	31	7/8
140230-6-8 C	3/8	1/2	34	31	1
140230-8-6 C	1/2	3/8	34	37	7/8
140230-8-8 C	1/2	1/2	36	37	1
140230-8-12 C	1/2	3/4	42	37	1.1/4
140230-12-6 C	3/4	3/8	38	40	7/8
140230-12-8 C	3/4	1/2	39	40	1
140230-12-12 C	3/4	3/4	42	40	1.1/4
140230-16-12 C	1	3/4	46	50	1.1/4
140230-16-16 C	1	1	49	50	1.1/2
140230-20-20 C	1.1/4	1.1/4	54	61	1.7/8
140230-24-24 C	1.1/2	1.1/2	59	67	2.1/8
140230-32-32 C	2	2	69	76	2.5/8

Adaptador com ref. em Aço Carbono (C)

1 - Materiais dos Adaptadores: **Aço Inoxidável (S) = 140230-8-8 S**

2 - Consulte para outras combinações de Rosca NPT / NPSM.

ADAPTADORES - SAE J514

CURVA PORCA GIRATÓRIA NPSM / MACHO NPT (Swivel Male 45° Elbow)

140330.....

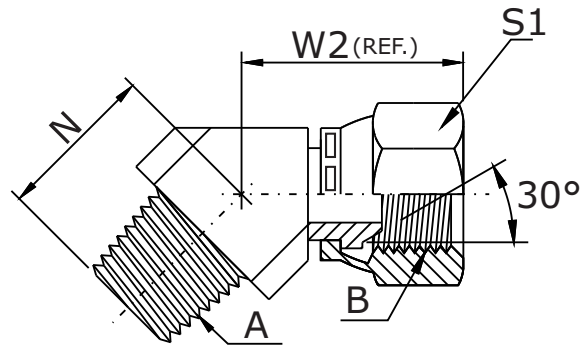

Ref.	Rosca A NPT	Rosca B NPSM	W2 (Ref.)	N	S1
140330-2-2 C	1/8	1/8	20	13	9/16
140330-4-4 C	1/4	1/4	23	22	3/4
140330-6-6 C	3/8	3/8	28	24	7/8
140330-8-6 C	1/2	3/8	28	30	7/8
140330-8-8 C	1/2	1/2	30	30	1
140330-8-12 C	1/2	3/4	31	31	1.1/4
140330-12-8 C	3/4	1/2	31	31	1
140330-12-12 C	3/4	3/4	35	31	1.1/4
140330-16-12 C	1	3/4	37	38	1.1/4
140330-16-16 C	1	1	39	38	1.1/2
140330-20-20 C	1.1/4	1.1/4	41	42	1.7/8
140330-24-24 C	1.1/2	1.1/2	45	45	2.1/8
140330-32-32 C	2	2	48	54	2.5/8

Adaptador com ref. em Aço Carbono (C)

1 - Materiais dos Adaptadores: **Aço Inoxidável (S) = 140330-8-8 S**

2 - Consulte para outras combinações de Rosca NPT / NPSM.

ADAPTADORES - SAE J514

UNIÃO PORCA GIRATÓRIA NPSM / MACHO UNF (Swivel Male Stud)

140157.....

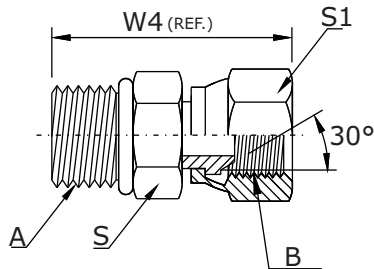

Ref.	Rosca A UN/UNF	Rosca B NPSM	W4 (Ref.)	S	S1
140157-4-4 C	7/16-20	1/4	34	9/16	3/4
140157-6-4 C	9/16-18	1/4	34	3/4	3/4
140157-6-6 C	9/16-18	3/8	35	3/4	7/8
140157-6-8 C	9/16-18	1/2	40	3/4	1
140157-8-4 C	3/4-16	1/4	36	7/8	3/4
140157-8-6 C	3/4-16	3/8	37	7/8	7/8
140157-8-8 C	3/4-16	1/2	40	7/8	1
140157-8-12 C	3/4-16	3/4	46	1	1.1/4
140157-10-8 C	7/8-14	1/2	44	1	1
140157-12-8 C	1.1/16-12	1/2	48	1.1/4	1
140157-12-12 C	1.1/16-12	3/4	50	1.1/4	1.1/4
140157-16-16 C	1.5/16-12	1	54	1.1/2	1.1/2
140157-20-20 C	1.5/8-12	1.1/4	56	1.7/8	1.7/8
140157-24-24 C	1.7/8-12	1.1/2	61	2.1/8	2.1/8
140157-32-32 C	2.1/2-12	2	63	2.3/4	2.5/8

Adaptador com ref. em Aço Carbono (C)

1 - Materiais dos Adaptadores: **Aço Inoxidável (S) = 140157-8-8 S**

2 - Consulte para outras combinações de Rosca UN/UNF / NPSM.

ADAPTADORES - SAE J514

JOELHO PORCA GIRATÓRIA NPSM / MACHO UN/UNF (Swivel Male Elbow)

140257.....

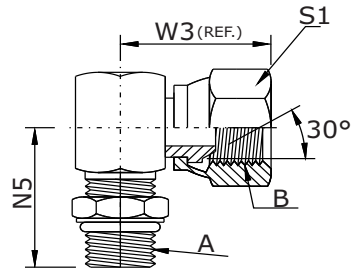

Ref.	Rosca A UN/UNF	Rosca B NPSM	W3 (Ref.)	N 5	S1
140257-4-4 C	7/16-20	1/4	25	26	3/4
140257-6-4 C	9/16-18	1/4	27	32	3/4
140257-6-6 C	9/16-18	3/8	28	32	7/8
140257-6-8 C	9/16-18	1/2	34	35	1
140257-8-6 C	3/4-16	3/8	30	37	7/8
140257-8-8 C	3/4-16	1/2	34	37	1
140257-8-12 C	3/4-16	3/4	42	41	1.1/4
140257-10-6 C	7/8-14	3/8	32	43	7/8
140257-10-8 C	7/8-14	1/2	36	43	1
140257-10-12 C	7/8-14	3/4	42	45	1.1/4
140257-12-8 C	1.1/16-12	1/2	38	49	1
140257-12-12 C	1.1/16-12	3/4	42	49	1.1/4
140257-16-16 C	1.5/16-12	1	49	52	1.1/2
140257-20-20 C	1.5/8-12	1.1/4	55	57	1.7/8
140257-24-24 C	1.7/8-12	1.1/2	59	61	2.1/8

Adaptador com ref. em Aço Carbono (C)

1 - Materiais dos Adaptadores: **Aço Inoxidável (S) = 140257-8-8 S**

2 - Consulte para outras combinações de Rosca UN/UNF / NPSM.

ADAPTADORES - SAE J514

**CURVA PORCA GIRATÓRIA
NPSM / MACHO UN/UNF
(Swivel Male 45° Elbow)**

140357.....

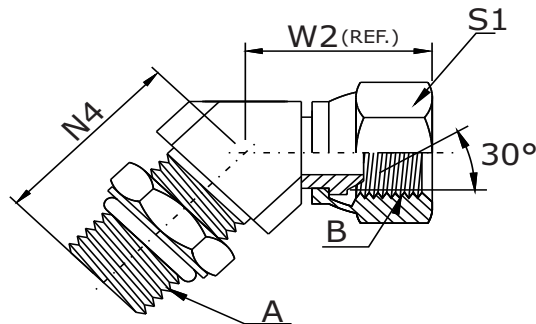

Ref.	Rosca A UN/UNF	Rosca B NPSM	W2 (Ref.)	N4	S1
140357-4-4 C	7/16-20	1/4	20	27	3/4
140357-6-6 C	9/16-18	3/8	26	29	7/8
140330-8-6 C	3/4-16	3/8	26	33	7/8
140357-8-8 C	3/4-16	1/2	30	33	1
140357-8-12 C	3/4-16	3/4	35	36	1.1/4
140357-10-8 C	7/8-14	1/2	30	39	1
140357-12-12 C	1.1/16-12	3/4	35	44	1.1/4
140357-16-16 C	1.5/16-12	1	39	47	1.1/2

Adaptador com ref. em Aço Carbono (C)

1 - Materiais dos Adaptadores: **Aço Inoxidável (S) = 140357-8-8 S**

2 - Consulte para outras combinações de Rosca UN/UNF / NPSM.

ADAPTADORES - SAE J514

UNIÃO PORCA GIRATÓRIA NPSM / FEMEA NPT (Swivel Male Stud)

140131.....

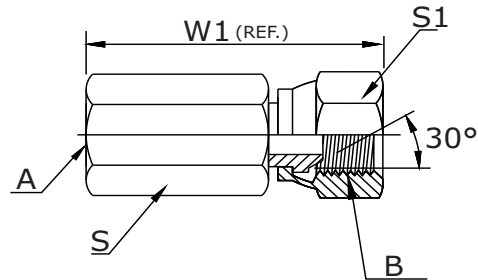

Ref.	Rosca A NPT	Rosca B NPSM	W1 (Ref.)	S	S1
140131-2-2 C	1/8	1/8	26	9/16	9/16
140131-4-4 C	1/4	1/4	36	3/4	3/4
140131-6-4 C	3/8	1/4	38	7/8	3/4
140131-6-6 C	3/8	3/8	38	7/8	7/8
140131-8-6 C	1/2	3/8	42	1	7/8
140131-8-8 C	1/2	1/2	46	1	1
140131-12-12 C	3/4	3/4	50	1.1/4	1.1/4
140131-16-16 C	1	1	60	1.1/2	1.1/2
140131-20-20 C	1.1/4	1.1/4	61	1.7/8	1.7/8
140131-24-24 C	1.1/2	1.1/2	62	2.1/8	2.1/8
140131-32-32 C	2	2	65	2.5/8	2.5/8

Adaptador com ref. em Aço Carbono (C)

1 - Materiais dos Adaptadores: **Aço Inoxidável (S) = 140131-8-8 S**

2 - Consulte para outras combinações de Rosca Fêmea NPT / NPSM.

ADAPTADORES - SAE J514

JOELHO PORCA GIRATÓRIA NPSM / FÊMEA NPT (Swivel Elbow)

140231.....

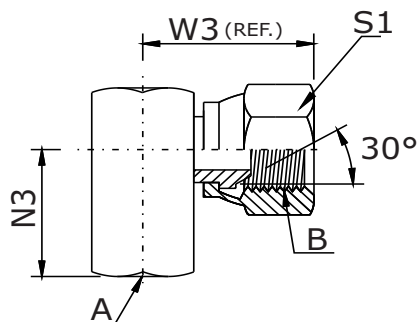

Ref.	Rosca A NPT	Rosca B NPSM	W3 (Ref.)	N3	S1
140231-2-2 C	1/8	1/8	24	17	9/16
140231-4-4 C	1/4	1/4	30	22	3/4
140231-6-6 C	3/8	3/8	32	26	7/8
140231-8-8 C	1/2	1/2	39	31	1
140231-12-12 C	3/4	3/4	46	35	1.1/4
140231-16-16 C	1	1	53	41	1.1/2
140231-20-20 C	1.1/4	1.1/4	56	43	1.7/8
140231-24-24 C	1.1/2	1.1/2	72	53	2.1/8
140231-32-32 C	2	2	76	61	2.5/8

Adaptador com ref. em Aço Carbono (C)

1 - Materiais dos Adaptadores: **Aço Inoxidável (S) = 140231-8-8 S**

2 - Consulte para outras combinações de Rosca NPT / NPSM.